

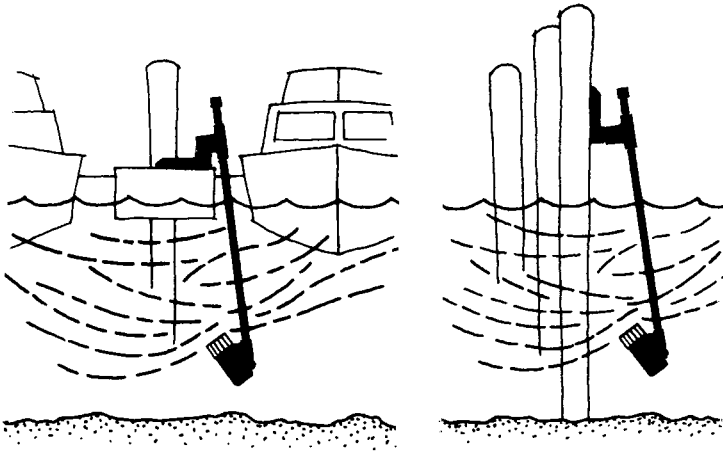

Assembly Instructions for Universal Dock or Piling Mount for Kasco De-Icers

Your Kasco piling or dock mount kit contains the necessary hardware to assemble one mounting system for use with a Kasco de-icing unit. (Because of shipping limitations users must supply their own 1" galvanized pipe extension and coupling.)



Parts Provided

- Draw-ring
- Necessary bolts with nuts and washers
- Piling or dock bracket (mounting lag screws or bolts by user)
- Adjustable de-icer pipe attachment (Pipe extension and safety coupling by user.)

The Universal Piling or Dock Mount is recommended for use only with Kasco's F2400, F3400 and 4400 De-Icers.

Step-By-Step Assembly: (Read all steps before beginning.)

Customer must provide 1" galvanized threaded pipe extension not more than 10 feet in length. Since applications may vary, user will supply appropriate lag screws or bolts to secure dock or piling bracket. Kasco urges that bracket be mounted as securely as possible. **For salt water use, Kasco suggests that you use 1" stainless steel pipe.**

Step 1

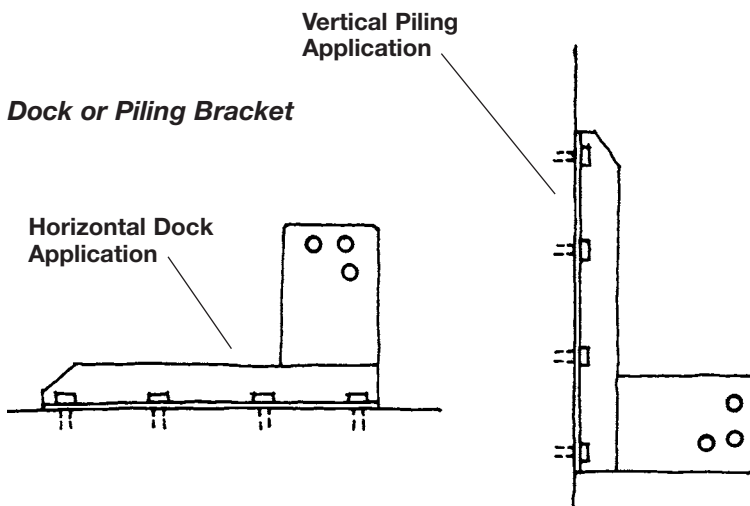

Determine the most suitable application for your situation. Kasco's universal mount may be used in either vertical or horizontal position.

Bracket **must** be attached to piling or dock as securely as possible.

(continued)

Step 2

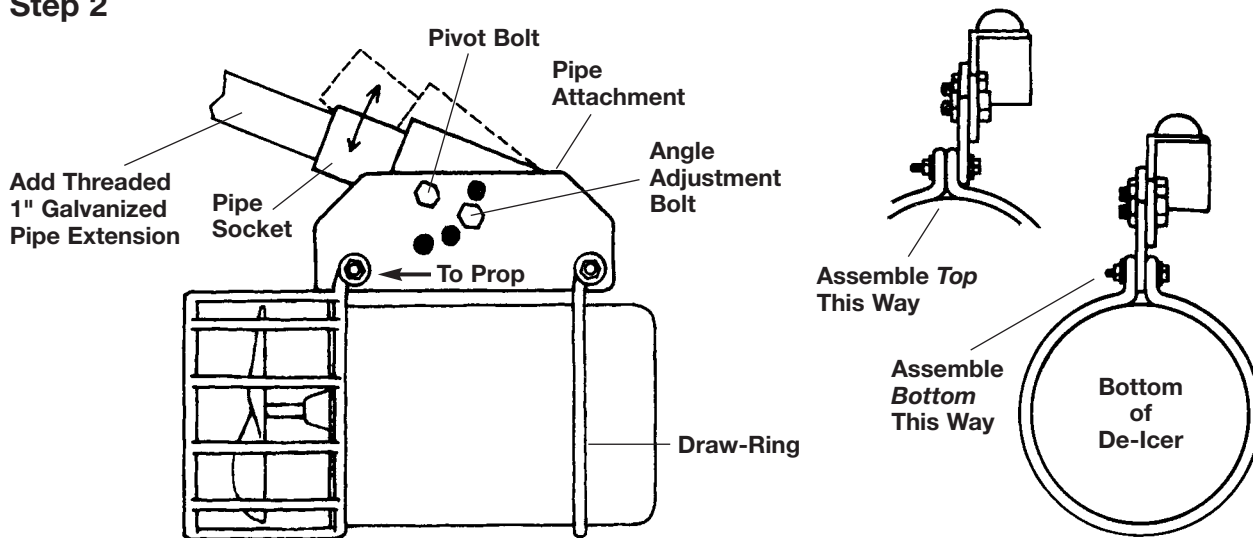

Remove any mooring lines still attached to your Kasco® De-Icer propeller cage. Remove 5/16" x 1-3/4" propeller cage mounting bolt. Slide draw-ring over bottom of de-icer as shown. Point yellow arrow toward de-icer propeller and secure pipe attachment to **outside** of propeller cage clamps with the new 5/16 x 1-3/4" bolt furnished. Position bottom of pipe attachment **between** draw-ring clamps and secure with old 5/16" x 1-1/4" bolt from propeller cage (see above).

Turn threaded pipe extension (more than 10 feet is **not** recommended) into pipe socket and make fully secure.

Step 3

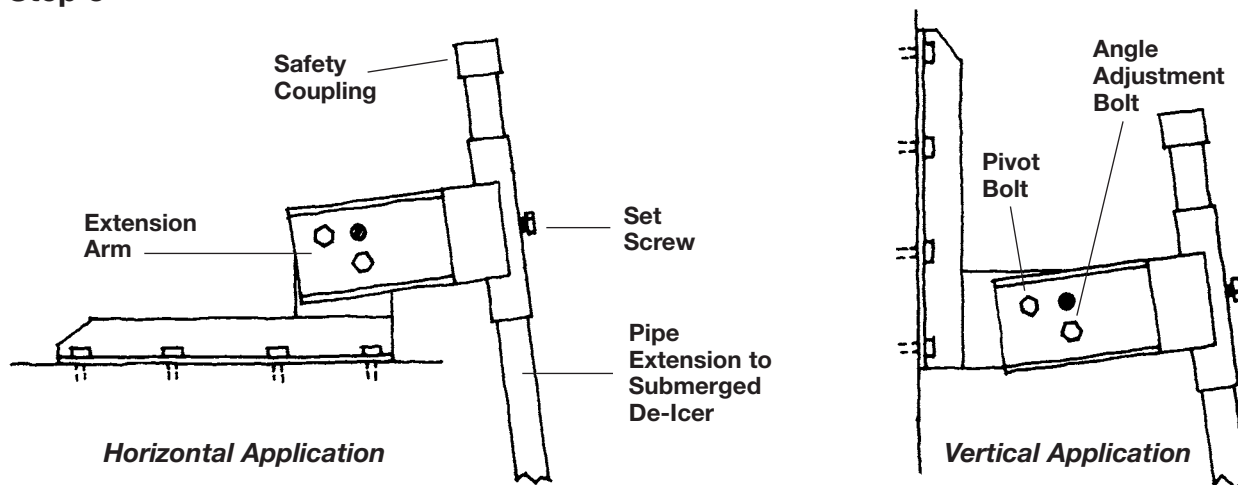

Slide opposite end of pipe extension thru extension arm and securely attach safety coupling. Now attach entire assembly to mounting bracket and with 1/2" x 1-1/4" bolts provided.

Adjust depth and angle thrust of de-icer for maximum spread of agitated water. Fully secure all bolts and nuts. Remember to leave slack in power cord, but keep free of propeller cage.